

How to make an EDGE™ connection

Cutting the pipe

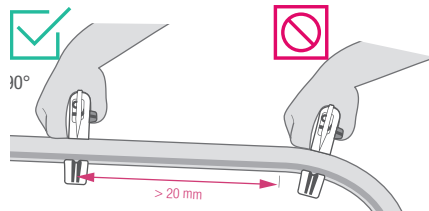

- Prior to cutting the pipe ensure the cut length accounts for the insertion depth of the pipe into the EDGE™ fitting (approximately 1 sleeve length).
- Select the appropriate pipe cutter
- Cut the pipe at 90° and without burrs.
- If the pipe was cut improperly, re-cut the pipe to ensure a square and burr-free cut.

Sliding the EDGE™ sleeve onto the pipe

EDGE™ sleeves are reversible and can be put onto the pipe in either direction

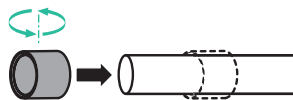

Inserting the pipe

- Remove the protective cap
- Insert the pipe. There should be a slight resistance.
- After insertion, check the correct insertion depth via the inspection windows. The pipe must completely fill the inspection window.

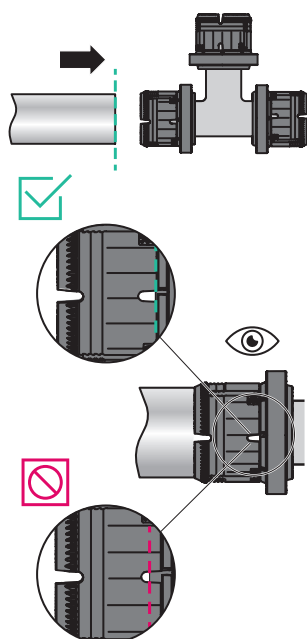

Compressing the joint

Joint before compression

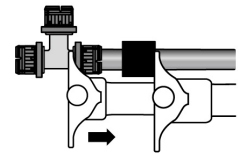

Joint after compression

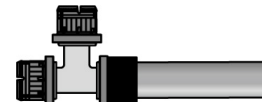

- Push the sleeve towards the inner sleeve far enough that you are able to place the jaws on the outside edge of the sleeve and the outside edge of the clip.
- Place the tool jaws over the pipe, so that it is in firm contact with the pipe and fitting body, as well as the outer edge of the sleeve and outer edge of the clip.
- Double check the insertion depth of the pipe through the inspection windows prior to compression.
- Compress the joint.

Approved pipe cutters for EDGE™ pipe

Pipe cutter 16/20 (stabil)



Pipe cutter 25



Pipe cutter 40



Rothenberger Rocut TC32



Approved compression jaws for EDGE™

Only use compression jaws approved for EDGE™. These jaws come in black colour while the jaws used for RAUTITAN range comes in golden colour.



Installation and Operating Temperatures

Minimum installation temperature is -5°C .
Maximum installation temperature is $+50^{\circ}\text{C}$.

EDGE™ can sustain an operating temperature of 70°C at 8 bar pressure or 60°C at 10 bar for life span 50 years.

Refer to EDGE™ TI for more information, including operating parameters for Ring main applications.

Handy tips

- Always pressure test system on completion and before covering the pipe or fittings as per AS/NZS 3500.
- Keep the protective caps on the fitting up until the joint is made to ensure no debris, falling dust, timber or steel shavings get into the connection area.
- The inner sleeve can be removed by hand to wipe the barb clean when required. Follow the instructions below to re-attach.
- Perform jointing only on a straight pipe section, not on a pipe bend or with pipe inserted at an angle. Avoid excessive bending stress on the connection.

Reusing jointing components

REHAU EDGE™ fittings shall not be reused or detached and must be disposed.

Re-attaching the inner sleeve

In case the inner sleeve has been dislodged from the fitting body, push it back onto the clip by hand

Note the direction of insertion: Inner sleeve groove on the clip, chamfer on the other side

Check the correct position of the inner sleeve: Hold the clip and turn the inner sleeve at the same time. The inner sleeve shall be easy to turn and shall not come off from the clip

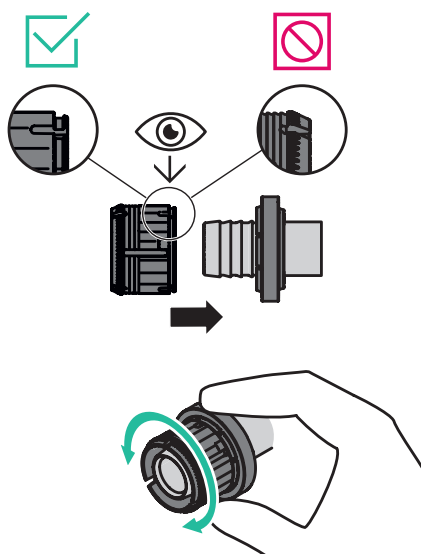

Safety information

- Only use EDGE™ PE-Xa pipes SDR 9 (silver, red, green, and lilac) and no other pipe.
- Protect EDGE™ pipes and fittings from contact with alcohol (e.g. Isopropanol, Ethanol, and Methylated Spirits), acetic acid, grease and oil, petrolatum, primers, solvents, glues/adhesives, paint and lacquer and other harmful substances.

Transition to other materials

IMPORTANT: Brazing shall not be performed on or near EDGE™ fitting under any circumstances.

Transition to copper

Transition to a copper installation system can be performed by using a >B< press copper crimp as an interim piece between an EDGE™ copper adapter and a copper pipe. The EDGE™ copper adapter has the same OD as AS 1432 compliant copper pipes. Thus, it fits directly into a copper crimp fitting with socket ends.

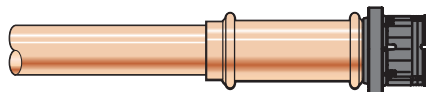

Transition to stainless steel

A direct transition to stainless steel system is not approved. The transition to stainless steel pipe shall be carried out by connecting a non-stainless steel interim piece (i.e. gunmetal or flush valve) to a EDGE™ threaded fittings.

Scan the QR code and read all instructions provided before installing EDGE™.



<http://qr.rehau.com/d3c5181a9a>